

Aldreds
Estate Agents

11 St. Benets Road

Gorleston, Great Yarmouth, NR31 7LY

£180,000



11 St. Benets Road

Gorleston, Great Yarmouth, NR31 7LY

With gardens to front & rear, Aldreds offer this spacious three bedroom mid terrace house. On the ground floor there is an entrance porch, entrance hall, lounge, dining room and a kitchen. The first floor offers three bedrooms, shower room and WC off landing. Sealed unit double glazing. No chain.

Entrance Porch

Door to front

Entrance Hall

Stairs to landing, electric heater

Lounge

12'11" x 11'10" (3.94 x 3.62)

Double glazed window to front aspect, electric fire in stone fireplace, stone TV display plinths

Dining Room

9'10" x 9'4" (3.02 x 2.87)

Double glazed window to rear aspect, electric fire in brick fireplace

Kitchen

9'4" x 8'9" (2.86 x 2.68)

Base & wall units with worktops, door to rear, double glazed window to rear aspect, electric cooker point, sink with drainer, plumbing for washing machine

Landing

Bedroom 1

12'11" x 11'10" (3.95 x 3.63)

Double glazed window to front aspect

Bedroom 2

13'1" x 9'10" (4 x 3)

Double glazed window to rear aspect

Bedroom 3

13'1" max 5'4" min x 7'8" max 4'5" min (4 max 1.63 min x 2.36 max 1.35 min)

Double glazed window to front aspect





Shower Room

Shower in cubicle, hand basin, opaque double glazed window to rear aspect, electric heater

WC

Low level WC, part tiled walls, opaque double glazed window to rear aspect

Outside

To the front there is a pathway to front door, lawned garden with bushes & shrubs. To the rear there is a well kept lawned garden with bushes & shrubs, brick shed, two paved patios

Tenure

Freehold

Services

Mains water, electricity, drainage

Council Tax

Band B

Location

Gorleston on Sea is a coastal town 2 miles from Great Yarmouth centre and has a varied selection of local shops * Golf Course * Modern District hospital * Schools for all ages * Library * Regular bus services to the main shopping areas and a sandy beach.

Directions

From the Gorleston office head south along the High Street, at the traffic lights turn right into Church Lane, at the roundabout turn left into Middleton Road, continue past the water works turning right into Gloucester Avenue, turn right into St. Benets Road where the property can be found on the right hand side.

Ref G18410/11/25



Floor Plan

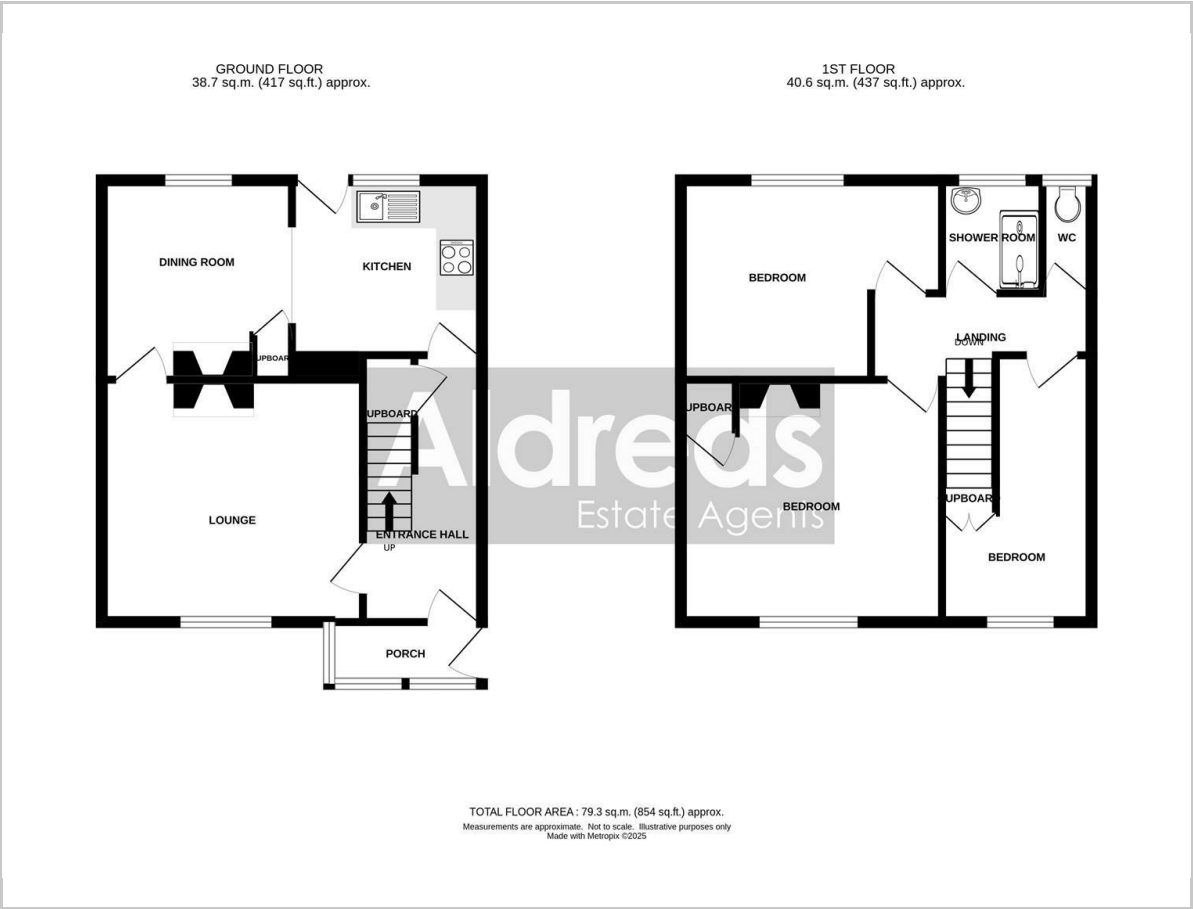

Area Map

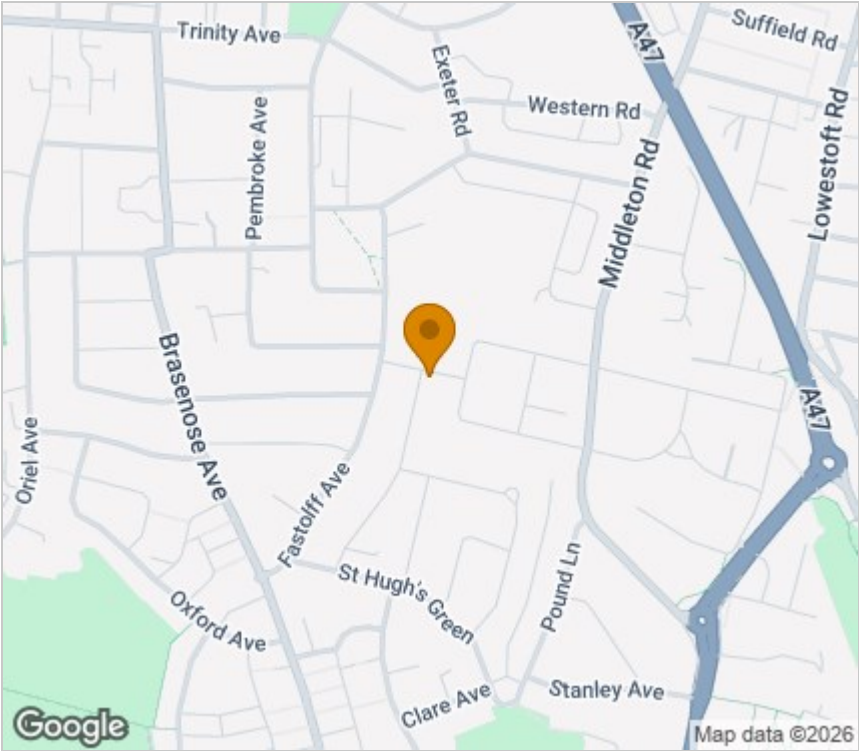

Energy Efficiency Graph

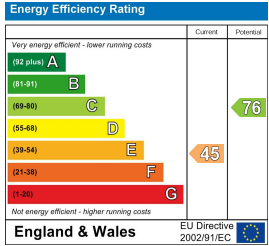

Viewing

Please contact our Aldreds Gorleston Office on 01493 664600 if you wish to arrange a viewing appointment for this property or require further information.

Disclaimer
These particulars are issued on an understanding that all negotiations shall be conducted through Messrs. Aldreds. Please note: Messrs. Aldreds for themselves and for the vendors or lessors of this property whose agents they are given notice that: 1. Particulars are set out as a general outline only for guidance of intending purchasers or lessees, and do not constitute nor constitute part of, an offer or contract. 2. All descriptions, dimensions, references to condition and necessary permissions for use and occupation, and other details are given without responsibility and any intending purchasers or tenants should not rely on them as statements or representations of fact but must satisfy themselves by inspection or otherwise as to the correctness of each of them. 3. No person in the employment of Messrs. Aldreds has any authority to make or give any representation or warranty whatever in relation to this property. 4. If you are proposing to visit the property and are travelling some distance please check with Aldreds on the issue of availability prior to travelling. 5. Aldreds Property Consultants and associated services may offer additional services to the prospective purchaser for which they will be entitled to receive a commission. Aldreds are pleased to be working with Mortgage Advice Bureau. They're an award-winning mortgage broker with over 1,400 advisers across the UK, and have access to over 12,000 mortgage products from over 90 lenders. Aldreds Estate Agents Ltd receive a commission of £200 on each completed case. Your home may be repossessed if you do not keep up repayments on your mortgage. There may be a fee for mortgage advice. The actual amount you pay will depend upon your circumstances. The fee is up to 1%, but a typical fee is 0.3% of the amount borrowed. Mortgage Advice Bureau is a trading name of Mortgage Seeker Limited which is an appointed representative of Mortgage Advice Bureau Limited and Mortgage Advice Bureau (Derby) Limited which are authorised and regulated by the Financial Conduct Authority. Mortgage Seeker Limited Registered Office: Lovewell Blake, Sixty Six North Quay, Great Yarmouth, Norfolk, NR30 1HE. Registered in England Number: 03721415. 6. Potential purchasers should check with their providers that the broadband and mobile phone coverage they would require is available.

149 High Street, Gorleston, Norfolk, NR31 6RB
Tel: 01493 664600 Email: gorleston@aldreds.co.uk <https://www.aldreds.co.uk/>
Registered in England Reg. No. 08945751 Registered Office: 17 Hall Quay, Great Yarmouth, Norfolk NR30 1HJ
Directors: Mark Duffield B.S.c. FRICS. Dan Crawley MNAEA Paul Lambert MNAEA